

Russell Row, 56 Popham Close
Tiverton, Devon, EX16 4GA

£1,300 PCM



 4  1  3 **EPC C**



Located within a desirable development on the edge of town, this three-storey town house is well laid out for multiple living. Sorry not suitable for pets. EPC: C

Lettings

The property is available to rent on a six monthly renewable Assured Shorthold Tenancy, unfurnished.

Rent: £1,300 per calendar month exclusive of all charges.

Deposit: £1,500.00 returnable at the end of tenancy, subject to any deductions.

Permitted Payments:

As well as paying the rent, you may also be required to make the following permitted payments Before the tenancy starts (payable to Seddons Lettings 'the Agent')

Holding Deposit: 1 week's rent

Deposit: 5 weeks' rent

The holding deposit, the equivalent of one week's rent, will be allocated to the first month's rent once satisfactory references have been received. The holding deposit is non-refundable if a tenant withdraws their application once referencing has commenced or if misleading information is provided or information is withheld on the application form.

* Referencing charges do not apply to tenants of assured shorthold tenancies, student accommodation, or licences but may apply for other types of tenancy i.e. company lets and contractual tenancies.

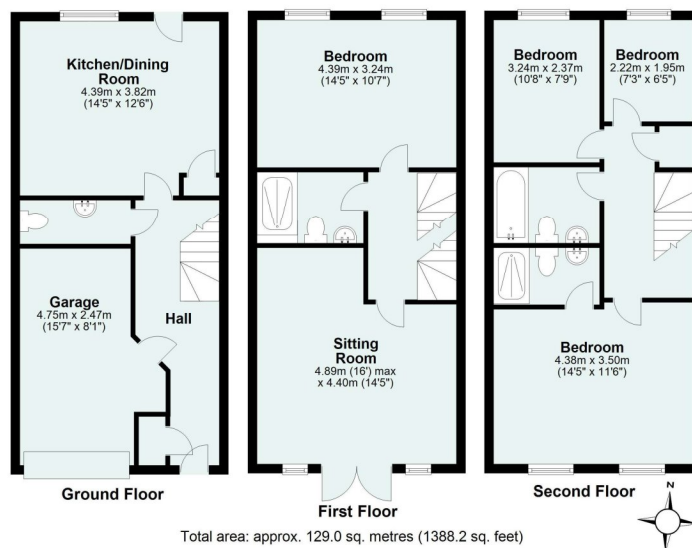

Utilities: Mains electric, gas, water, and drainage.

Council Tax: Band D

Energy Performance Certificate (EPC)

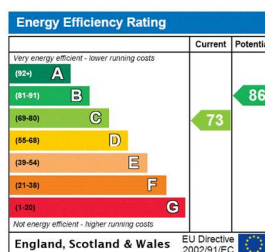

Whilst every attempt is made to ensure our sales particulars are fair and accurate, they are only a general guide to the property and must not be relied on. Please qualify any specific points of interest with Seddons.